

Pick-Up & Drop-Off

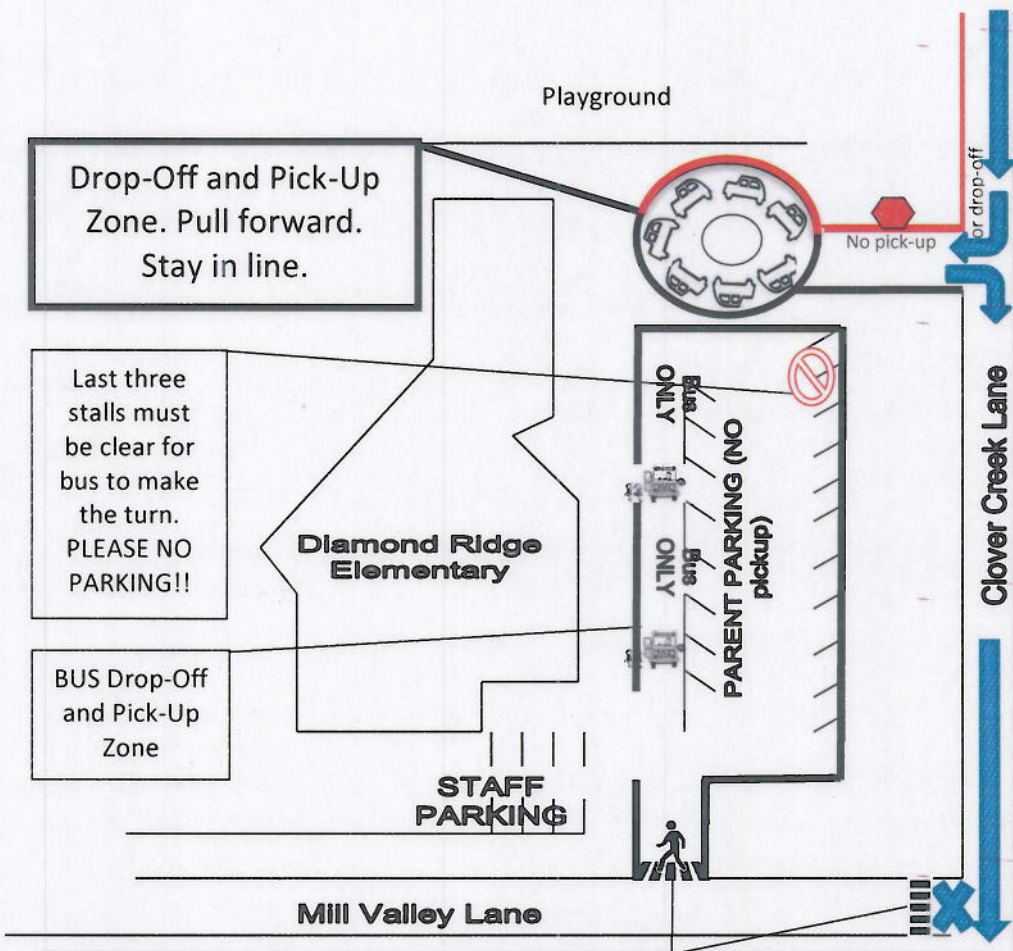

Students cross at these crosswalks. Please use the correct drop-off zone to protect their walkways. No right turn onto Mill Valley Lane from Clover Creek.

NO pick-up/drop-off in ANY parking lots. Please use pick-up circle.

To alleviate congestion on Clover Creek Lane, please wait in line along Clover Creek to the north of the school. After dropping off or picking up, EXIT THE CIRCLE TO THE SOUTH (right hand turn). For student safety, please follow Clover Creek Lane to Wakefield Way in order to avoid students walking along Mill Valley Lane.

We need your help to keep our students safe. The pick-up/drop-off zone was established to allow you to drop-off students by pulling to the right side of the curb, unloading/loading, then pulling back into the traffic flow.

Students may not be dropped off from the traffic lane. Walking in front of cars causes an extremely dangerous situation.

If all positions in the pick-up circle are full, wait on Clover Creek Lane. Do not park in or in front of a driveway. Stay in line, moving forward as space becomes available. Don't pass other vehicles to move forward.

Also, remember to use the drop off zone, not the bus area in front of the school. Using the bus area or parking lot creates an unsafe situation as you exit the south entrance where many walking students are crossing and walking home.

Thank you for helping us keep students safe!