

Kearns High School

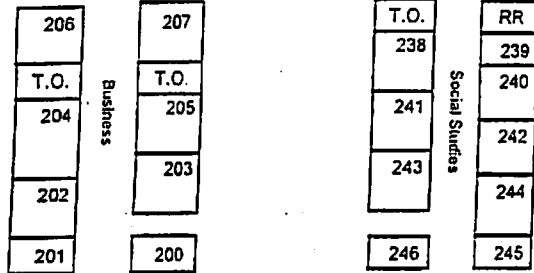
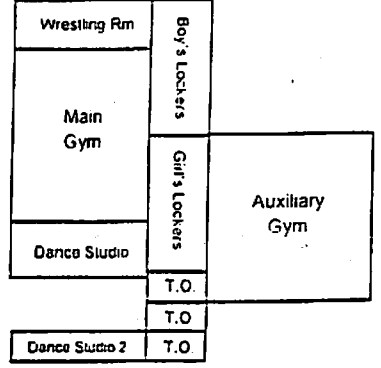
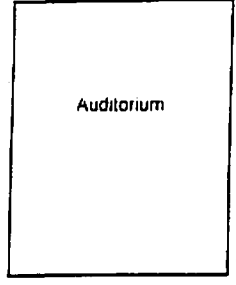
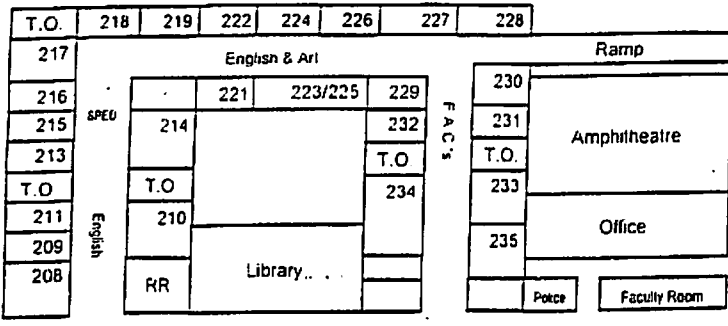
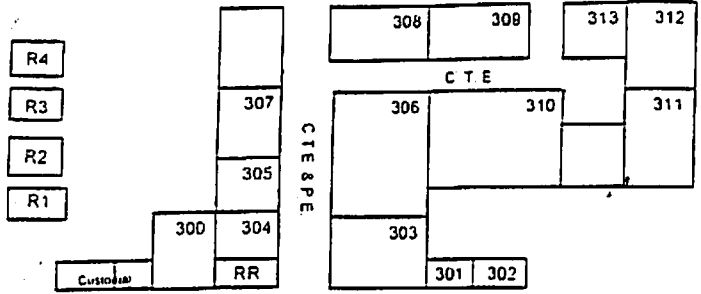

LOCKERS WILL NOT BE AVAILABLE TO OPEN UNTIL THE WEEK BEFORE SCHOOL STARTS

How to select your locker

- Go to <http://kearns.lockerassignment.com/>
- Log In using your student number
Your password is your initials (first letter of your first name & first letter of your last name) and then your student number ie—Mary Smith M5952634
- Select a zone (see map)
 - *Downstairs (1 - 682 and 2375 - 2626)
 - *Upstairs (686 - 2150)
 - *CTE/Shop (2151 - 2374)
- Available lockers will come up for you to choose from
- Once you have selected a locker you will be shown the combination.
- If you forget your combination you can log back in to <http://kearns.lockerassignment.com/> and look up your locker and combination at any time.
- How to open your locker:
 - Turn knob right at least two whole turns and stop at first number
 - Turn knob left one whole turn past first number and stop at second number
 - Turn right and stop at last number

Upper Level

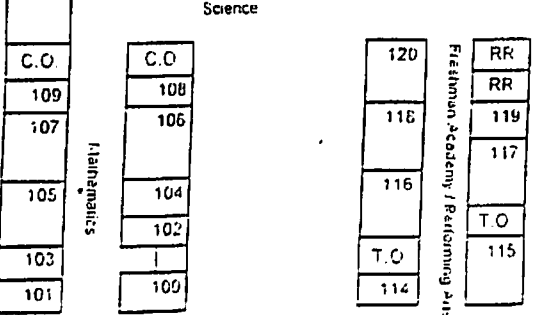
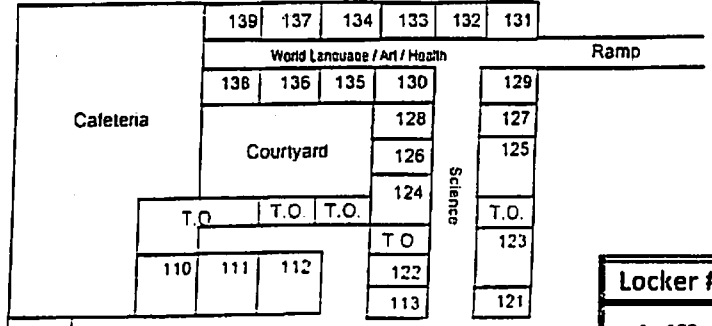

Lower Level

Locker Locations

Locker #		Room #	Locker #		Room #
1 - 182	Downstairs	110 - 112	1251 - 1284	Upstairs	Main Hall by Stairs
183 - 307	Downstairs	110 - 112	1285 - 1433	Upstairs	208 - 217
308 - 481	Downstairs	113 - 130	1434 - 1596	Upstairs	218 - 228
482 - 548	Downstairs	131 - 133	1597 - 1751	Upstairs	230 - 235
549 - 685	Downstairs	121 - 129	1752 - 1900	Upstairs	229 - 234
686 - 778	Upstairs	239 - 245	1901 - 2050	Upstairs	219 - 228
779 - 816	Upstairs	245 - 246	2051 - 2150	Upstairs	210 - 214
817 - 942	Upstairs	239 - 245	2151 - 2245	CTE/Shop Hall	308 - 313
943 - 1016	Upstairs	Hall West of Library	2246 - 2374	CTE/Shop Hall	306 - 310
1017 - 1114	Upstairs	200 - 207	2375 - 2502	Downstairs	101 - 109
1115 - 1152	Upstairs	200 - 201	2503 - 2626	Downstairs	100 - 108
1153 - 1250	Upstairs	201 - 206			